

www.ipdirect2u.com

www.ipdirect2u.com

LLOYDS BRITISH TESTING LTD



UK
Tel: 0800 035 3035
Email: sales@lloydsbritish.com



UNITED ARAB EMIRATES
Tel: 00971 (04) 266 5274
Email: sales@lloydsbritishdubai.com



EGYPT
Tel: (0020) 229704862
Email: sales@lloydsbritishegypt.com



KUWAIT
Tel: (00965) 476 4590
Email: sales@lloydsbritishkuwait.com



INDIA
Tel: +91 33 225 22185
Email: sales@lloydssomersindia.com



ANGOLA
Tel: 0020 2297064861
Email: sales@lloydsbritish.com



SAUDIA ARABIA
Tel: (00966) 3 8273050
Email: sales@lloydsbritish.com

INDUSTRIAL
PRODUCTS DIRECT

KEY CLIENTS OF LLOYDS INCLUDE:



ipd
INDUSTRIAL
PRODUCTS DIRECT
LIFTING EQUIPMENT • JACKING EQUIPMENT • LOAD MEASUREMENT • LASHING EQUIPMENT • MATERIAL HANDLING • SAFETY EQUIPMENT

PRODUCT CATALOGUE





Dear All
Welcome to our
new Lloyds British
Industrial Products
Direct catalogue.



'Lloyds British Industrial Products division specialises in the supply of a comprehensive range of Lifting, Materials Handling, Safety equipment and Restraint Systems, Engineering products, Jacking equipment and Access equipment.'

Operating through both a central National Contacts centre and a network of strategically placed branches throughout the UK and overseas, the division is fully supported by a dedicated team of staff who have a range of expertise and who collectively, can respond to any technical or commercial enquiries fast and efficiently, offering extensive Lifting and Materials Handling solutions.

As well as many of our products being stocked at our central stores and branches throughout the UK, we can custom build equipment to customer specification through our manufacturing divisions who can also design for more specialist applications.

As part of the Lloyds British Group we can offer you further assistance through the Installation, Testing and Certification of equipment as well as providing relevant Training courses, so you can be assured of an unrivalled service at all times'.

Our dedicated sales team is waiting to take your order!

Kind Regards

Steve Downing
 Director

OUR SERVICE GUARANTEE

We promise to deliver the highest standards of equipment and service nationally and locally to you

HEALTH & SAFETY

With penalties for non-compliance increasing each year, employed and self-employed persons have never been so exposed to potential risks before. Legislation now clearly requires Health & Safety to be professionally managed and with so many individual laws affecting the workplace and the use of work equipment, compliance is mandatory.

Peace of mind is achieved by using the proven services of the market leader, Lloyds British Testing. With our own team of full-time and in-house safety professionals, working safely within the law is assured

VARIETY OF PAYMENT OPTIONS

Open an Account

Company registration number will be required if you wish to set up a 30 day account (subject to approval)

Cheque / Postal Orders

Please make payable to Lloyds British Testing

Credit / Debit Cards:

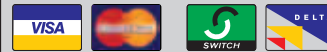

	LIFTING EQUIPMENT	3
	LOAD MEASUREMENT	22
	SAFETY EQUIPMENT	23
	MATERIAL HANDLING	31
	JACKING EQUIPMENT	41



TO PLACE AN ORDER

It's so easy, pick up the phone and talk through your requirements with a member of our sales team or contact any of our overseas companies listed below.

They will be happy to assist and offer any advice you may need.

CALL: +44 (0)800 0 35 30 35 FAX: +44 (0)800 0 38 00 04

EMAIL: sales@ipdirect2u.com



UNITED ARAB EMIRATES
 Tel: 00971 (04) 266 5274
 Email: sales@lloydsbritishdubai.com



EGYPT
 Tel: (0020) 229704862
 Email: sales@lloydsbritishegypt.com



KUWAIT
 Tel: (00965) 476 4590
 Email: sales@lloydsbritishkuwait.com



INDIA
 Tel: +91 33 225 22185
 Email: sales@lloydssomersindia.com



ANGOLA
 Tel: 0020 2297064861
 Email: sales@lloydsbritish.com



SAUDIA ARABIA
 Tel: (00966) 3 8273050
 Email: sales@lloydsbritish.com





Miller Weblift



ROUNDSLING			FLAT WEBBING SLING					
Including colour coded range, woven stripe, showing safe working load. 1 Stripe = 1 tonne. Up to 8.0t. Manufactured to EN 1492-2 as applicable.			Including colour coded range, soft eye and metal end fitting rings AL 1, AL 2, AL 3, AL 4, AL 5. Duplex. Manufactured to EN 1492-1 as applicable.					
Other sling types and lifting capacities are available on request								
★ DENOTES NOT AVAILABLE			LIFTING FACTOR	Vertical x1	Choke x 0.8	D ^o Basket x 2	Basket D ^o 45° x 1.4	Basket 45° 60° x 1
ROUND SLING	SINGLE SLING	ENDLESS & DUPLEX SLING	LIFTING MODE	I	h	U		
Average dia (mm)	Width (mm)	Strips (mm)	COLOUR	Tonnes	Tonnes	Tonnes	tonnes	tonnes
★	30	★	BLACK	500kg	400kg	1.0	700kg	500kg
20	60	30&50	VIOLET	1.0	800kg	2.0	1.4	1.0
★	90	★	WHITE	1.5	1.2	3.0	2.1	1.5
24	120	60	GREEN	2.0	1.6	4.0	2.8	2.0
28	180	90	YELLOW	3.0	2.4	6.0	4.2	3.0
32	240	120	GREY	4.0	3.2	8.0	5.6	4.0
36	300	150	RED	5.0	4.0	10.0	7.0	5.0
40	300	180	BROWN	6.0	4.8	12.0	8.4	6.0
48	★	240	BLUE	8.0	6.4	16.0	11.2	8.0
55	★	300	ORANGE	10.0	8.0	20.0	14.0	10.0
59	★	300	ORANGE	12.0	9.6	24.0	16.8	12.0
65	★	300	ORANGE	15.0	12.0	30.0	21.0	15.0
76	★	300	ORANGE	20.0	16.0	40.0	28.0	20.0
88	★	600	ORANGE	25.0	20.0	50.0	35.0	25.0
100	★	600	ORANGE	30.0	24.0	60.0	42.0	30.0
115	★	600	ORANGE	40.0	32.0	80.0	56.0	40.0
130	★	★	ORANGE	50.0	40.0	100.0	70.0	50.0



KUPLEX 8+10

Setting the standard in chain lifting systems

WORKING LOAD CAPACITY - TONNES

Grade	8	10	12	15	20	25	30	35	40	45	50	55	60	65	70	75	80	85
-------	---	----	----	----	----	----	----	----	----	----	----	----	----	----	----	----	----	----

6	8	1.12	1.6	1.12	2.36	1.7	1.8											
7	8	1.5	2.12	1.5	3.15	2.24	2.5											
7	10	2	2.8	2	4.2	3	3.2											
8	8	2	2.8	2	4.2	3	3.2											
10	8	3.15	4.25	3.15	6.7	4.75	5											
10	10	4	5.6	4	8.4	6	6.4											
13	8	5.3	7.5	5.5	11.2	8	8.5											
13	10	6.7	9.5	6.7	14	10	10.7											
16	8	8	11.2	8	17	11.8	12.5											
16	10	10	14	10	21.2	15	16											
19	8	11.2	16	11.2	23.6	17	18											
19	10	14	20	14	30	21	22.4											
23	8	16	23.6	16	35.5	25	26.5											
23	10	21	29.5	21	44	31.5	33.5											
26	8	21.2	30	21.2	45	31.5	33.5											
26	10	27	38	27	57	40	43											
32	8	31.5	45	31.5	67	47.5	50											
32	10	40	56	40	85	60	65											

Never exceed the working load limit marked on the sling. Never use a sling at angles greater than 60° from the vertical.

The most versatile chain lifting system in the world

Kuplex 8+10™ is the world's first and only dual grade chain sling system and offers the widest range of chains and components to make it the most versatile chain system ever.

Over two years of research and development using the latest technology and CAD facilities for full stress analysis, Kuplex 8+10™ has a massive 25% extra strength and lifting power over comparable Grade 8 units with a full range of components available to handle loads up to 85 tonnes.





- Increased load capacity of 25% over Grade 8
- Easier handling where smaller size chain can be used
- Lower cost per kilo lifted
- Interchangeable components to repair Grade 8 slings
- Higher wear resistance gives longer service life
- Extensive range of fittings
- The latest chain technology at a competitive price



Factor of Safety	1-leg chains		2-leg chains		3- and 4-leg chains		Endless chain	Basket chains	
	0° to 45°	45° to 60°	0° to 45°	45° to 60°	0° to 45°	45° to 60°		0° to 45°	0° to 45°
4	1.00	1.40	1.00	1.40	2.00	2.00	1.60	1.40	2.00
Working angles	1.40	2.00	1.40	1.60	3.00	3.00	2.24	2.00	3.00
Angle of spread	1.90	2.65	1.90	2.12	4.00	4.00	3.00	2.65	4.00
Load factor	2.50	3.55	2.50	2.80	5.30	5.30	4.00	3.55	5.30
	4.00	5.60	4.00	4.25	8.00	8.00	6.30	5.60	8.00
	6.70	9.50	6.70	7.50	14.00	14.00	10.60	9.50	14.00
	10.00	14.00	10.00	11.20	21.20	21.20	16.00	14.00	21.20
	14.00	20.00	14.00	16.00	30.00	30.00	22.40	20.00	30.00
	19.00	26.50	19.00	21.20	40.00	40.00	30.00	26.50	40.00
	26.50	37.50	26.50	30.00	56.00	56.00	42.50	37.50	56.00
	21.20	30.00	21.20	23.70	45.00	45.00	33.50	30.00	45.00
	31.50	45.00	31.50	35.20	67.00	67.00	50.00	45.00	67.00
Code	Working Load Limit [tonnes]								
WIN 5	1.00	0.80	1.00	0.80	2.00	1.50	1.60	1.40	2.00
WIN 6	1.40	1.12	1.40	1.12	3.00	2.12	2.24	2.00	3.00
WIN 7	1.90	1.50	1.90	1.50	4.00	2.80	3.00	2.65	4.00
WIN 8	2.50	2.00	2.50	2.00	5.30	3.75	4.00	3.55	5.30
WIN 10	4.00	3.15	4.00	3.15	8.00	6.00	6.30	5.60	8.00
WIN 13	6.70	5.30	6.70	5.30	14.00	10.00	10.60	9.50	14.00
WIN 16	10.00	8.00	10.00	8.00	21.20	15.00	16.00	14.00	21.20
WIN 19	14.00	11.20	14.00	11.20	30.00	21.20	22.40	20.00	30.00
WIN 22	19.00	15.00	19.00	15.00	40.00	28.00	30.00	26.50	40.00
WIN 26	26.50	21.20	26.50	21.20	56.00	40.00	42.50	37.50	56.00
NI 26 G8	21.20	16.95	21.20	16.95	45.00	31.50	33.50	30.00	45.00
NI 32 G8	31.50	25.20	31.50	25.20	67.00	47.50	50.00	45.00	67.00



WINNER

Stainless Steel Chain Slings and Components Grade 50 AISI 316

Safety factor	1-leg chains		2-leg chains		3- and 4-leg chains		Endless sling	Basket chains				
4												
Angle of inclination			up to 45°	45°-60°	up to 45°	45°-60°		up to 45°	up to 45°			
Load factor	1	0.8	1.4	1	1.52	0.8	2.1	1.5	2.1			
Load capacity [kg]												
NIK 6	6	900	400	700	500	800	400	1050	750	900	700	1050
NIK 7	7	1000	800	1400	1600	1120	800	2100	1500	1600	1400	2100
NIK 10	10	2000	1600	2800	3200	2240	1600	4200	3000	3200	2800	4200
NIK 13	13	3200	2560	4500	5200	3550	2560	6700	4750	5120	4500	6700
NIK 16	16	4800	3840	6800	7800	5440	3840	10000	7125	7680	6800	10000

* Reduction of WLL due to the use of eye sling hooks

Should the chains be subject to additional loads, the values given in the table above be multiplied by all the corresponding load factors indicated below.



Pump lifting chains

Stainless Steel lifting accessories can be used for general lifting purposes covering a wide range of designs, loads and slings. Details are given in line with Uniform Load Method.

Actual Chain Temperature	-45° - 400°C		400° - 600°C		600 - 700°C	
Load factor	1		0.75		0.5	
Asymmetric load distribution						
Angle of inclination	up to 45°	45° - 60°	up to 45°	45° - 60°	up to 45°	45° - 60°
Load factor	0.7	1	0.7	1	0.7	0.7
Edge load	R = larger than 2x chain Ø		R = larger than chain Ø		sharp, hard edges	
Load factor						
Shock Load factor	slight shocks		medium shocks		strong shocks not permissible	
	1		0.7			

Fabricated Wire Ropes, Slings and Fittings



The latest revision of British Standard BS 1290 :1983 "Wire rope slings and sling legs for general lifting purposes" has served to rationalise the varying methods of calculating the Safe Working Load of the various configurations of wire rope slings. The effect of this rationalisation has been to limit the types of wire ropes, used in general purpose sling assemblies, to a specific range of sizes, constructions, and tensile grades: moreover, it introduces the internationally accepted 'Uniform Load' method of calculating the Safe Working

Load in preference to the trigonometric method. In this standard, the Safe Working Loads for all slings are based on one fifth of the Minimum Breaking Load of the rope.

It should be pointed out that BS 1290 :1983 covers only those sling assemblies that have legs of equal nominal length, diameter, construction and tensile grade. While sling assemblies with legs of unequal length may be made up generally in accordance with the requirements of BS 1290 :1983, it must be stressed that their rating requires special consideration by a competent person.

Wire rope sling configurations

When single leg slings are used either alone or in pairs, the Safe Working Load (SWL) can be affected.

Some examples are given here.

Cradle Sling
Lifting coils, steel strip, etc.

Basket Hitch
SWL = 1.4 x WLL of sling

Protect Rope
from sharp corners.

Cradle Slings
Lifting boilers and packaging cases, etc.

Double Basket Hitch
SWL = 2.1 x WLL of sling.

Halving Slings

Method using a single sling in place of an endless sling where a "bight" is required. A stirrup fitted temporarily in the bight will minimise damage to the sling.

Double and Choked
SWL = 1.6 x WLL of sling.

Double Warp Slings
Note how the double wrap grips the load and helps to prevent it from slipping sideways out of the slings.

Double Wrap Basket Hitch
SWL = 2.1 x WLL of sling.

Combination Slings

Timber steel sheets and packing cases, etc.

N.B. Maximum angle between legs is 90°

Reeving Slings
Lifting tubes, bars and rods, etc.

Double Choke Hitch
SWL = 1.1 x WLL of sling.

Alloy Shackles – US Federal Specification RR-C-271D IV

Dimensions					
SWL tonnes	d Inches	D Inches	S Inches	W Inches	Weight kgs/each
0.50	1/4	5/16	7/8	15/32	0.05
0.75	5/16	3/8	1 1/32	15/32	0.08
1.00	3/8	7/16	1 1/4	21/32	0.14
1.50	7/16	7/16	1 7/16	23/32	0.22
2.00	1/2	5/8	1 5/8	19/16	0.38
3.25	5/8	3/4	2	1 1/16	0.66
4.75	3/4	7/8	2 5/8	1 1/4	1.05
6.50	7/8	1	2 9/16	1 1/16	1.46
8.50	1	1 1/8	3 1/16	1 11/16	2.59
9.50	1 3/8	1 1/4	3 1/16	1 13/16	3.35
12.00	1 1/4	1 3/8	3 5/16	2 1/32	4.71
13.50	1 3/8	1 1/2	4 1/16	2 1/4	6.12
17.00	1 1/2	1 5/8	4 7/8	2 5/8	7.60
25.00	1 3/4	2	5 3/4	2 7/8	13.00
35.00	2	2 1/4	6 3/4	3 1/4	18.72
55.00	2 1/2	2 3/4	8	4 1/8	35.10

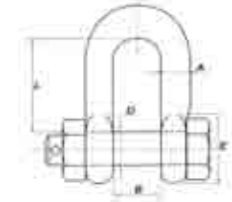
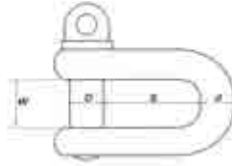

Large Bow Shackles – To BS 3032 1958 with Type 'A' Pins

Dimensions								
SWL tonnes	d Inches	D Inches	W Inches	2 x r Inches	S Inches	E Inches	Weight kgs/each	
0.15	1/4	3/8	1/2	3/4	1 1/8	3/4	0.08	
0.45	3/8	1/2	3/8	1	1 1/8	1	0.10	
0.75	1/2	5/8	7/8	1 1/4	2 1/8	1 1/4	0.30	
1.25	5/8	3/4	1 1/8	1 3/8	2 3/4	1 1/2	0.60	
2.00	3/4	7/8	1 3/8	2	3 3/8	1 3/4	1.00	
2.75	7/8	1	1 5/8	2 1/4	3 7/8	2	1.60	
3.75	1	1 1/8	1 3/4	2 1/2	4 1/4	2 1/4	2.40	
4.75	1 1/8	1 1/4	2	2 3/8	4 7/8	2 1/2	3.40	
5.75	1 1/4	1 3/8	2 1/4	3 1/4	5 5/8	2 3/4	4.80	
7.25	1 3/8	1 1/2	2 1/2	3 1/2	6	3	6.20	
8.50	1 1/2	1 3/4	2 3/4	3 3/8	6 5/8	3 1/2	9.10	
9.50	1 5/8	1 7/8	3	4 3/8	7 3/8	3 3/4	10.40	
11.50	1 3/4	2	3 3/8	4 3/4	8 1/8	4	13.10	
13.00	1 7/8	2 1/8	3 5/8	5 1/8	8 3/4	4 1/4	15.90	
15.00	2	2 1/4	3 7/8	5 1/2	9 3/8	4 1/2	19.50	
18.50	2 1/4	2 1/2	4 1/8	6	10 1/8	5	27.70	
20.00	2 3/8	2 5/8	4 3/8	6 3/8	10 3/4	5 1/4	32.70	
25.00	2 5/8	2 7/8	4 3/4	7	11 1/8	5 3/4	44.00	

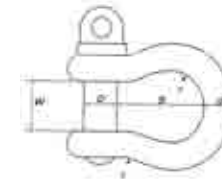

Dimensions						
SWL tonnes	d Inches	D Inches	S Inches	W Inches	2 x r Inches	Weight kgs/each
0.33	3/16	1/4	7/8	3/8	5/16	0.02
0.50	1/4	5/16	1 1/8	15/32	3/4	0.06
0.75	5/16	3/8	1 1/4	17/32	13/16	0.09
1.00	3/8	7/16	1 1/16	21/32	15/16	0.15
1.50	7/16	1/2	1 11/16	23/32	1 1/16	0.24
2.00	1/2	5/8	1 7/8	19/16	1 1/16	0.39
3.25	5/8	3/4	2 13/32	1 1/16	1 1/2	0.73
4.75	3/4	7/8	2 27/32	1 1/4	1 3/4	1.30
6.50	7/8	1	3 5/16	1 1/16	2	1.82
8.50	1	1 1/8	3 3/4	1 11/16	2 5/16	2.59
9.50	1 1/8	1 1/4	4 1/4	1 13/16	2 5/8	3.60
12.00	1 1/4	1 3/8	4 11/16	2 1/32	2 7/8	5.12
13.50	1 3/8	1 1/2	5 1/4	2 1/4	3 1/4	6.96
17.00	1 1/2	1 5/8	5 3/4	2 3/8	3 3/8	8.93
25.00	1 3/4	2	7	2 7/8	4 1/2	14.24
35.00	2	2 1/4	7 3/4	3 1/4	5 1/4	21.10
55.00	2 1/2	2 3/4	10 1/2	4 1/8	6 3/4	42.73
85.00	3	3 1/4	13	5	7 3/8	65.91
120.00	3 1/2	3 3/4	15	5 1/4	9	114.00
150.00	4	4 1/4	17	5 1/2	10 1/2	163.00

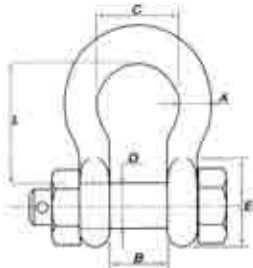

Large D Shackles – To BS 3032 1958 Type 'A' Pins

Dimensions						
SWL tonnes	d Inches	D Inches	W Inches	S Inches	E Inches	Weight kgs/each
0.25	1/4	3/8	1/2	1	3/4	0.10
0.50	3/8	1/2	3/4	1 1/2	1	0.20
0.75	1/2	5/8	1 1/8	2 1/8	1 1/4	0.30
1.50	5/8	3/4	1 1/4	2 1/2	1 1/2	0.60
2.00	3/4	7/8	1 1/2	2 3/8	1 3/4	1.00
3.00	7/8	1	1 3/4	3 1/4	2	1.60
3.75	1	1 1/8	2	3 3/4	2 1/4	2.30
5.00	1 1/8	1 1/4	2 3/8	4 1/8	2 1/2	3.20
6.00	1 1/4	1 3/8	2 3/8	4 1/2	2 3/4	4.50
7.00	1 3/8	1 1/2	2 3/8	5	3	6.10
9.50	1 1/2	1 3/4	2 3/4	5 3/8	3 1/2	8.70
11.25	1 5/8	1 7/8	3	5 3/4	3 3/4	10.00
13.00	1 3/4	2	3 1/4	6 1/8	4	12.50
14.25	1 7/8	2 1/8	3 3/8	7	4 1/4	15.20
16.25	2	2 1/4	3 3/8	7 3/8	4 1/2	18.50
18.00	2 1/8	2 3/8	4 1/8	7 3/4	5	20.00
20.00	2 1/4	2 1/2	4 1/4	8 1/4	5 1/4	22.20
25.00	2 1/2	2 3/8	4 3/4	9 1/4	5 3/4	26.30
30.00	2 3/4	3 1/8	5 1/4	10 1/4	6 1/4	31.10
35.00	3	3 3/8	5 3/4	11	6 3/4	62.70

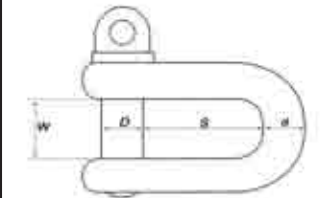

Eye Bolts – To BSS 4278 Part 1 1984 – Tested and Certified

VERTICAL SWL tonnes	Dimensions							
	A mm	B mm	D mm	E mm	F mm	G mm	H mm	Weight kgs/each
0.10	M6	22	7	15	9	20	18	0.07
0.15	M8	22	7	15	9	20	18	0.07
0.25	M10	22	7	15	9	20	18	0.07
0.40	M12	22	7	15	9	20	18	0.07
0.50	M14	29	10	20	12	26	23	0.15
0.80	M16	29	10	20	12	26	23	0.16
1.00	M18	36	12	24	14	32	28	0.28
1.60	M20	40	14	27	16	36	32	0.44
1.60	M22	45	15	30	18	40	35	0.56
2.50	M24	52	17	35	21	46	40	0.84
2.50	M27	58	20	39	23	52	46	1.14
4.00	M30	65	22	44	26	58	51	1.66
4.00	M33	72	24	48	28	64	56	2.24
6.30	M36	81	27	54	32	72	63	3.17
6.30	M39	90	30	60	36	80	70	3.92
8.00	M42	101	34	68	40	90	79	6.00
8.00	M45	101	34	68	40	90	79	6.00
10.00	M48	101	34	68	40	90	79	6.00
12.50	M52	115	38	76	46	102	89	9.00

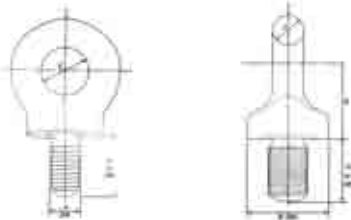

Eye Bolts with Links

SWL tonnes	Dimensions					Link Dimensions			Weight kgs/each
	a mm	b mm	d mm	f mm	h mm	d mm	Bd mm	Ld mm	
0.20	M12	39	9	12	27	13	24	53	0.40
0.40	M16	39	9	12	27	13	24	53	0.40
1.00	M20	39	9	12	27	13	24	53	0.50
1.60	M24	47	11	14	32	15	29	63	0.80
2.50	M30	60	14	18	41	19	37	80	1.50
4.00	M36	75	17	23	52	24	46	102	3.00
5.00	M45	94	22	29	65	30	58	126	5.50
6.30	M48	94	22	29	65	30	58	126	5.50

Hand Chain Hoists



Exclusive to Lloyds

Size Range:
5000kg – 30 tonne
Please advise at time of ordering:
Safe working load (SWL)
Height of lift

Pneumatic Hoists



Size Range:
25kg – 50 tonne
Please advise at time of ordering:
Safe working load (SWL)
Height of lift
Cord or pendant control
Pendant Length

Electric Chain Hoists



Size Range:
250kg – 10 tonne
Voltage
110v – 415v
Please advise at time of ordering:
Safe working load (SWL)
Height of lift
Pendant Length

Ratchet Lever Hoists



Exclusive To Lloyds

Size Range:
500kg – 9 tonne
Please advise at time of ordering:
Safe working load (SWL)
Height of lift

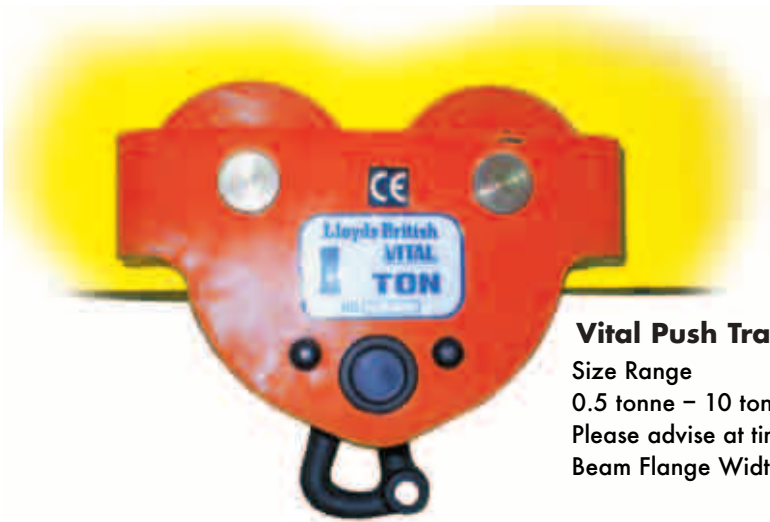

Vital Push Travel Trolley

Size Range
0.5 tonne – 10 tonne
Please advise at time of ordering:
Beam Flange Width



Saflok Beam Clamp

Size Range
2 tonne – 30 tonne
Please advise at time of ordering:
Beam Flange Width



Vital Geared Beam Trolley

Size Range 0.5 tonne – 10 tonne
Please advise at time of ordering:
Height of lift beam
Flange Width



Saflok Beam Trolley

Size Range
0.5 tonne – 10 tonne
Please advise at time of ordering:
Beam Flange Width



TECHNICAL ADVICE HELPLINE

We offer specialist advice on lifting.
If you require help with our lifting equipment please call:
+44(0) 800 0 35 30 35

Bespoke Handling Equipment

Repetitive manual handling is a major cause of muskulo-skeletal injuries throughout industry. Why not reduce operator injury risks whilst minimising product damage and increasing profitability?

Vacuum assisted lifting is employed in thousands of companies Worldwide.

Vacuum Boxes Lifter



Vacuum lifter handling boxes with flexible handle feature for high stacking.



Vacuum Tube Lifter

This flexible system uses multiple suction to lift a number of items.

Sack Lifter



Sacks are taken from a pallet and effortlessly loaded onto a conveyor belt. The unit is suspended from an overhead gantry, which covers a large working area.

Lifting and Pulling Machines

Lifting and Pulling Machines can be used with an unlimited length of wire rope, they are recommended for applications where limited space and portability are important.

There are generally two ranges, a light duty and a heavy duty. They start at very light rating for lifting a load of 300kg and progress up to 3200kg for lifting and a rated pulling capacity of 5000kg. All models are available in powered options using hydraulic power pack and allowing remote operation.



Minifor Powered Hoist

Size Range 300kg – 500kg
Please advise at time of ordering:
Safe working load
Height of lift
length of pendant
voltage



Tirak Wire Rope Hoist

Size Range 300kg – 3 tonne
110v and 415v
Please advise at time of ordering:
Safe working load
Height of lift
length of pendant
voltage

Lightweight, Fully Adjustable, Fast Erection, Stationary



Lightweight, Fully Adjustable, Fast Erection, Stationary
The Gantry has four supporting posts, which can be adjusted to the height required. Due to its lightweight, the Crane can easily be carried by two people. Beam Supports are firmly fixed via hinges and can be adjusted in



height – a big advantage especially when operating on uneven ground. The Crane is equipped with four foot plates as standard. The height of the four telescopic supports can be adjusted in steps via bolts. The supports and beams are made from Aluminium sections. All other sections are made from Steel and painted.

Suitable for Air, Electric, and Hand Chain Hoists. The Aluminium Gantry is ideal for often changing sites and is available in Stationary and Mobile models 0.5t and 1t.

Adjustable Gantry



We supply a range of Adjustable Gantries for lifting up to 20 tonne. Please specify the safe working load, working height and span when ordering.

Wire Rope Winches

AC2000 Range

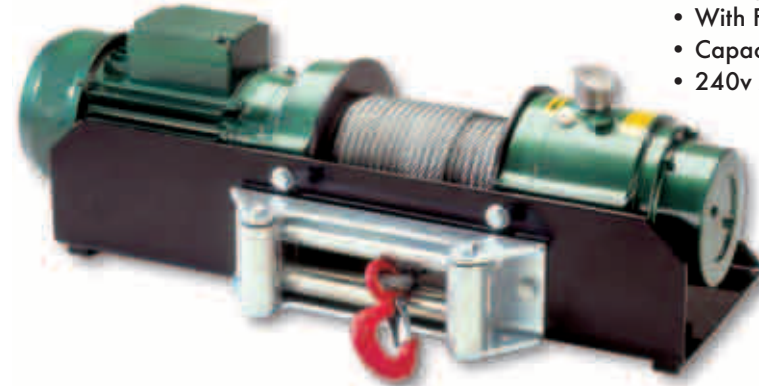

- Pulling
- With Freespool
- Capacities 500 - 2000kg
- 240v x 1ph or 415 x 3ph

CWL Compact Range



- Lifting or Pulling
- Capacity 200kg
- 110v or 240v x 1ph

CWG 10151 & 30151

- Lifting or Pulling
- Capacity 300 - 500kg
- 240v x 1ph / 415 x 3ph



Rough Terrain Pallet Truck



Unlike other All Terrain Pallet Trucks, the Conhersa machine is manufactured from round section steel tube and not subject to fractures. All wheels are water tight and have sealed for life bearings. The forks are width adjustable and can be adapted for use with any kind of pallet. The elevation system is hydraulic with a built in manual pump.

Also available in Battery Powered models.

Kerb Lifter



Lifting Capacity: 100kg
Lifting and moving kerbstones between 485mm and 1020mm in length

Manhole Cover Lifter



Hydraulic manhole cover lifter is suitable for lifting and removing man hole covers, including split covers with 2 or 4 key holes and recessed block paving.
Lifting Capacity: up to 1500kg
Single man operation

Two man kerb lift



Used to lift and lay kerbstones



Two Man Vacuum Slab lifter

Rechargeable battery powered vacuum slab lifter is suitable for lifting and laying concrete and natural slabs up to 150kg in weight.



Block Grabs

The block grab is suitable for lifting and transportation of packs of blocks, bricks, pavers, slabs and kerbs etc., up to loads of 1800kg. Capable of lifting pack sizes between 400 and 1110mm. Lifting eyes are supplied for fork lift operation

Mechanical Grab

The mechanical grab can be used for lifting heavy pre-cast concrete sections and other concrete products up to loads of 3000kg. The grab is fitted with rubber protectors to avoid damage to the product being lifted.





Paver Transport Cart

The Paver Transport Cart is used for the transportation of block paving from palletised or un-palletised packs.



One-Man Battery Slab Lifter

The one-man battery operated vacuum slab lifter is suitable for the lifting and laying of concrete and natural stone slabs up to 75 kg in weight.



Stone Magnet

The vacuum stone magnet is a powerful and cordless rechargeable battery operated lifting device for the laying of dense stone, slabs, concrete products etc. Capable of lifting loads up to 400kg. Can be used on all kinds of lifting equipment.

Load Cell Shackles



Please advise at time of ordering:
Information Required:
Jaw width
Pin diameter
SWL

Test Weights, Hand Weights & Stillage

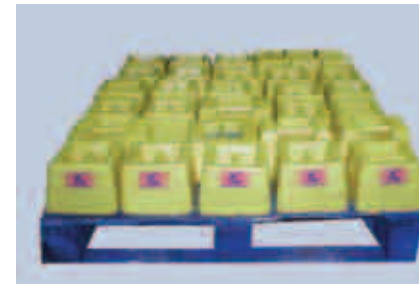

Various sizes available including rectangular, round and roller type.
Hand weights up to 25 kg.
Stillages to suit hand weights.
Also available test weight cradles up to 250 tonne.
Information Required:
Load of Test Weights required
Cradle – are slings and shackles required.

Tension Load links up to 100 tonne



Information Required:
Shackles and Safe working load

Technical Line:
Lloyds British offers specialist advise on lifting shifting and safety equipment.
If you require help or information with any of our products please call:
08000 35 30 35

Safety Fall Protection Jacket

FS4000

The perfect combination of a comfortable and practicable "Combi" work jacket with inbuilt light weight safety harness for fall protection

Available in colours

10 Orange
15 Lime
20 Hi-Vis Orange
30 Hi-Vis Lime

80 Hi-Vis Orange (Multirisk)
85 Hi-Vis Orange Rain Proof
90 Hi-Vis Lime (Multirisk)
95 Hi-Vis Lime Rain Proof

**UNIQUE
DESIGN
EXCLUSIVE
TO LLOYDS**



Fall Protection Overall

The unique Fall Protection overall incorporates an ultra-lite body harness within a protection boiler suit. No size adjustment is required to the harness as the overall is supplied in five different sizes.

The Fall Protection overall is available in 5 sizes:
C48, C50, C52,
C54, C56

How to order:
Make up the order
ref No. like this:
S200 + (colour) +
(size)
Example:
S200_40_C52

Colour Option Choose your
colour, available 4 options

Original Orange / Blue – The original Ekman Fall Protection vest style 60%. Polyester 40% Cotton, Heavy duty 300g/m². Water and dirt repellent fabric Fluorocarbon.

High Visibility Orange – High visibility orange with reflective stripes. Approved to EN471-1 60% Polyester 40% Cotton, Heavy duty 300g/m². Water and dirt repellent fabric Fluorocarbon.



- Original & High visibility
- Anti-flame
- Machine washable
- The perfect choice at large industrial plants and aviation maintenance
- No metal parts that could damage the aircraft
- European patent No: EP0235154B1

High Visibility Yellow – High visibility yellow with reflective stripes. Approved to EN471-1 60% Polyester 40% Cotton, Heavy duty 300g/m². Water and dirt repellent fabric Fluorocarbon.

Orange Antiflame – Orange anti-flame Proban Vulcano Approved to EN470-1, EN531 75% Cotton 25% Polyester Heavy Duty 335g/m².

Safety Fall Protection Vests



FS3610 Fall Protection Offshore Vest
EN358, EN361 EN396

- Integrated Harness
- Standard buckles
- Antiflame Fabric
- 150N Inflatable lifejacket



UNIQUE DESIGN EXCLUSIVE TO LLOYDS



FS301



FS301-20



Available in colors

- 10-Orange
- 20-Hi Vis Orange
- 30-Hi-Vis Lime
- 40-Anti-Flame Orange

Safety Helmet

FS3300

- Shell material ABS
- Tape suspension Nylon monofilament
- Headband material LDPE
- Harness slot in Nylon
- Chin strap elastic band
- Chin strap hook in Nylon
- Weight 310g
- Size 53 to 66cm



FS3300
Pin Lock



FS3300-2
Screw Lock



Fall Protection Harness

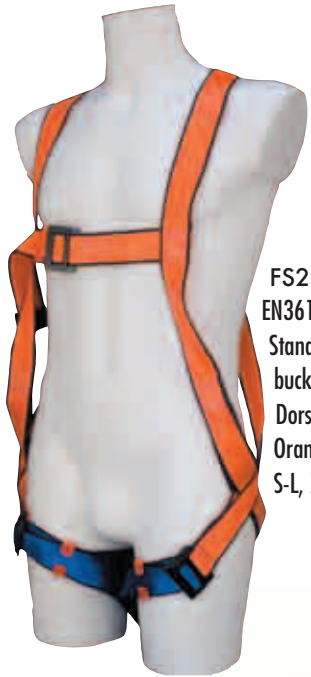

FS200
EN361
 Standard
 buckles
 Dorsal D ring
 Orange & Black
 S-L, XL- XXL



There are four main Fall Protection Systems that apply when working at height. The systems have differences in function and it is of importance to know the differences and choose the correct safety system for the work to be done.



FS201
EN201
 • Standard Buckles
 • Dorsal D ring
 • Front Attachment Via 2 Loops
 & Karabiner
 • Orange & Black
 • S-L, XL –XXL



Full Body Harness



FS211

Selection Guide.

The Ekman Safety Professional line includes products and systems for most Fall Protection applications



FS205



Lanyard with Energy Absorber



- FS501
Lanyard adjustable 2m
ENERGY II
EN354, EN355
- 1 large hook
 - 1 Karabiner
 - Energy Absorber
 - Double heavy duty webbing 25mm
 - 8-ring length adjuster 1,4 – 2m



- FS504
Lanyard with Energy Absorber
EN354, EN355
- 2 Karabiners
 - Stretchable webbing 43mm
 - Energy absorber
 - Length stretchable 2m

Double Lanyard



- FS505
Lanyard with Energy Absorber Double
EN354, EN355
- 2 large hooks
 - 1 Karabiner
 - Y leg Lanyard
 - Energy Absorber
 - Stretchable Webbing 43mm
 - Length Stretchable 2m



- FS502
Lanyard With Energy
absorber - Double
EN354 EN355
- 2 large hooks
 - 1 Karabiner
 - Y-leg Lanyard
 - Energy Absorber
 - Stretchable Webbing 43mm
 - Length Stretchable 2m

Fall Arrest – Block



- FS505
Fall Arrest Block 3m
EN360
- Aluminium housing
webbing cable

Rescue Systems



- FS903
Evacuation system Automatic descend
EN341
- Manual lift ascend/descend
 - Length 10m, 20m or 30m
 - Storage bag



- FS3300
Safety Helmet – Pin Lock
EN397. 1995
- Shell material ABS
 - Tape Suspension Nylon monofilament
 - Headband material LDPE
 - Harness slot in Nylon
 - Chin strap elastic band
 - Chin strap hook in nylon
 - Weight 310g
 - Size 53 to 66cm

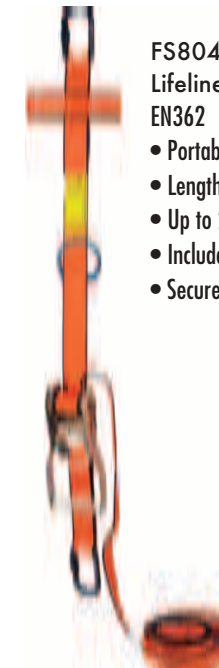

- FS804
Lifeline Safewalk
EN362
- Portable HLL System
 - Lengths 10m or 20m
 - Up to 2-person use
 - Includes storage bag
 - Secures side movements

Fork Mounted Jib



A fixed length jib which mounts onto the forks of a truck. The ideal attachment for lifting and conveying loads which are not suitable for, or do not require palletising. Supplied c/w hook and shackle which can be moved to any suitable lifting position.

Raised Drum Grab



Designed for use with 210 litre mouser open top and tight head egg shaped plastic drums. Arms close automatically around the base of the drum holding it securely during transportation. Fully automatic operation. Secured to truck by screw clamps.

Fork Mounted Hook



Simple and cost effective means of converting your fork lift truck into a mobile crane. Capacity 1000 – 5000 Kg.

Genie Superlift



The Genie Superlift is capable of lifting 454 Kg up to a height of 7.6m. The Superlift is available with a range of useful accessories including; barrel handler, load platform, extension forks, pipe cradle, barrel stacker and lifting boom.

Scissor Lifting Table



We supply a range of Scissor Lifting Tables, which are also trolleys, for shifting loads up to 2 tonne and raising to a height of 1.5m.

Gas Operated Lift



The Gas Operated Lift is capable of lifting 136 Kg up to a height of 5.5m. Ideal for duct installation and similar tasks.

SAL100

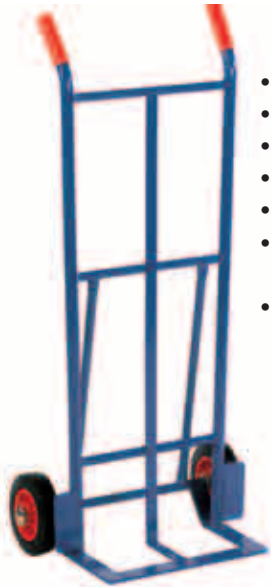

- Height 1065mm
- Width 510mm
- Shoe Length 160mm
- Shoe Width 370mm
- Weight 8kg
- Wheels: 160mm plastic centre, rubber type
- Carrying capacity: 120kg

SAL230



- Height 1120mm
- Width 400mm
- Shoe Length 210mm
- Shoe Width 400mm
- Weight 9kg
- Wheels: 200mm plastic centre, rubber type
- Carrying capacity: 200kg

SAL225

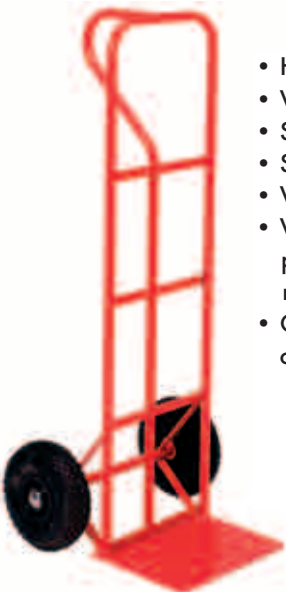

- Height 1300mm
- Width 570mm
- Shoe Length 230mm
- Shoe Width 370mm
- Weight 12kg
- Wheels: 260mm plastic centre, rubber type
- Carrying capacity: 200kg

SAS200



- Height 1220mm
- Width 550mm
- Shoe Length 470mm
- Shoe Width 310mm
- Weight 17kg
- Wheels: 160mm plastic centre, rubber type
- Carrying capacity: 150kg

Platform Trucks PLC302



(Other sizes available upon request)

- Platform length 1000mm
- Platform width 600mm
- Platform width 286mm
- Overall length 1150mm
- Handle height 1025mm
- End type Tubular
- Information required: Castor type

Platform Truck - Three Sided PLC307



- Platform Length 1000mm
- Platform width 600mm
- Platform height 286mm
- Overall length 1150mm
- Handle Height 1025mm
- Height ends and sides 550mm
- Type: Mesh
- Plywood sides available upon request

TECHNICAL ADVICE HELPLINE

**LLOYDS BRITISH OFFERS
SPECIALIST ADVICE ON LIFTING,
SHIFTING AND SAFETY EQUIPMENT.**

**IF YOU REQUIRE HELP WITH ANY
OF OUR PRODUCTS PLEASE CALL:**

0800 0 35 30 35

ALL PRODUCTS COME WITH 12 MONTHS ON SITE PARTS & LABOUR WARRANTY!

Warrior AC Low profile Hand Pallet Truck



- Minimum lowered height 51 mm
- 200kg
- 2 sizes
- Greasing points
- Overload/pressure relief valve
- Ideal for handling: crates, American /Japanese pallets
- Tandem Rollers
- Nylon Steer wheels

Eco Warrior AC2000 Hand Pallet Truck Spec to BS EN1752-2: 2001



- Product Information
- 2000kg
 - 100mm x 520mm
 - 1000mm x 680mm
 - Single Nylon Load Roller
 - Nylon Steer wheels
 - Sealed bearings
 - Greasing points
 - Pressure relief valve/overload valve
 - Self-lubricating bushes
 - Sealed hydraulics

Warrior AC Weight Scale Pallet Truck



- 200kg
- 2 sizes
- Polyurethane +/- 0.1%
- Totalising Function
- High contrast display
- High Battery Autonomy with 70 hours of use
- Water and dust proof to norm IP65
- Optional built in thermal printer

Warrior AC2500 Hand Pallet Truck



- A PREMIUM PALLET TRUCK
- Product Information
- 2500kg
 - 8 sizes
 - Long life tandem nylon or polyurethane rollers
 - Long life nylon or polyurethane steer wheels
 - 3-position trigger
 - Full bushing in key areas
 - Greasing points
 - Overload/pressure relief valve
 - Exit/entry Rollers

The large panel trolleys will carry boards up to 3050mm x 760 mm on their 200mm steel centre rubber tyre castors.

Trolley – Large Panel DBT304



- Overall Length 1500mm
- Overall width 700mm
- Overall Height 1500mm
- Load width 350mm
- Carrying capacity 350kg

Trolley – Large Panel DBT302 (has removable Board Support)



- Overall Length 1100mm
- Overall Width 600mm
- Overall Height 1150mm
- Load width 300mm
- Carrying capacity 350kg

TSK100SC – Turnable Trucks – Heavy Duty



The heavy-duty turnable trucks are built to the highest standard to withstand robust use. The turnable trucks have twin plate and kingpin method of turnable steering and a T handle which makes them suitable for all hand, pull applications.

- Length 1220mm
- Width 610mm
- Height 410mm
- Overall length 1360mm
- Carrying capacity 500kg
- Wheel: 200mm steel centre, rubber tyres.

Polyurethane tyred wheel with nylon centre - Plate Fixing (22)



Wheel Dia mm	Tread Width mm	Fitted Height mm	Swivel Offset mm	Load Capacity kg	Bearing Type	Swivel	Fixed	Swivel + Total Stop Brake
100	35	128	40	250	roller	4 22 PNB	4 29 PNB	4 22 PNB SWB
125	35	155	42.5	250	roller	5 22 PNB	5 29 PNB	5 22 PNB SWB
150	45	188	53	500	roller	6 22 PNB	6 29 PNB	6 22 PNB SWB
200	50	238	53	500	roller	8 22 PNB	8 29 PNB	8 22 PNB SWB

Polyurethane tyred nylonwheel (SL)



Wheel Dia mm	Tread Width mm	Fitted Height mm	Swivel Offset mm	Load Capacity kg	Bearing Type	Swivel	Fixed	Swivel + wheel Brake	Swivel + Total Stop Brake
100	35	140	33	250	roller	SL 4 PNB	SLF 4 PNB	SL 4 PNB BK	
125	35	165	39.5	300	roller	SL 5 PNB	SLF 5 PNB	SL 5 PNB BK	
150	45	190	45	600	roller	SL 6 PNB	SLF 6 PNB	SL 6 PNB BK	SL 6 PNB SWB
200	50	241	54	600	roller	SL 8 PNB	SLF 8 PNB	SL 8 PNB BK	SL 8 PNB SWB

TECHNICAL ADVICE HELPLINE

we offer specialist advice on lifting.

If you require help with your lifting equipment please call:

0800 0 35 30 35

Polypropylene wheel - Plate Fixing (V30B)



Wheel Dia mm	Tread Width mm	Fitted Height mm	Swivel Offset mm	Load Capacity kgs	Bearing Type	Swivel	Fixed	Swivel + Total Stop Brake
50	18	68	23	50	plain	v30B 050 POP P01		V32 050 POP P01
75	23	97	30	70	plain	v30B 075 POP P01		V32 075 POP P01

Nylon wheel - Plate Fixing (11SOV)



Wheel Dia mm	Tread Width mm	Fitted Height mm	Swivel Offset mm	Load Capacity kgs	Bearing Type	Swivel	Fixed	Swivel + Total Stop Brake
100	32	128	32	150	ball	411SOV NYBJ	419SOV NYBJ	411SOV NYBJ SWB
125	32	152	47.5	150	ball	511SOV NYBJ	519SOV NYBJ	511SOV NYBJ SWB

Polypropylene wheel - Bolt Hole Fixing (V30B)



Wheel Dia mm	Tread Width mm	Fitted Height mm	Swivel Offset mm	Load Capacity kgs	Bearing Type	Swivel	Fixed	Swivel + Total Stop Brake
50	18	67	23	50	plain	v30B 050 POP B10		V32 050 POP B10
75	23	95	30	70	plain	v30B 075 POP B10		V32 075 POP B10

Nylon wheel - Bolt Hole Fixing (11SOV)



Wheel Dia mm	Tread Width mm	Fitted Height mm	Swivel Offset mm	Load Capacity kgs	Bearing Type	Swivel	Fixed	Swivel + Total Stop Brake
100	32	128	32	150	ball	411SOV NYBJ BH10		411SOV NYBJ BH10 SWB
125	32	152	47.5	150	ball	511SOV NYBJ		511SOV NYBJ BH10 SWB

Nylon wheel - Plate Fixing (V30B)



Wheel Dia mm	Tread Width mm	Fitted Height mm	Swivel Offset mm	Load Capacity kgs	Bearing Type	Swivel	Fixed	Swivel + Total Stop Brake
100	27	132	38	80	roller	v30B 100 NYR P02		V32B 100 NYR P02
125	27	155	42	100	roller	v30B 125 NYR P02		V32B 125 NYR P02

Grey rubber tyred wheel with Polypropylene centre - Plate Fixing (11SOV)



Wheel Dia mm	Tread Width mm	Fitted Height mm	Swivel Offset mm	Load Capacity kgs	Bearing Type	Swivel	Fixed	Swivel + Total Stop Brake
100	30	128	32	85	roller	411SOV PSBW	419SOV PSBW	411SOV PSBW SWB
125	30	152	47.5	85	ball	511SOV PSWBJ	519SOV PSWBJ	511SOV PSWBJ SWB

Nylon wheel - Bolt Hole Fixing (V30B)



Wheel Dia mm	Tread Width mm	Fitted Height mm	Swivel Offset mm	Load Capacity kgs	Bearing Type	Swivel	Fixed	Swivel + Total Stop Brake
100	27	130	38	80	roller	v30B 100 NYR B12		V32B 100 NYR B12
125	27	153	42	100	roller	v30B 125 NYR B12		V32B 125 NYR B12

Grey rubber tyred wheel with Polypropylene centre - Bolt Hole Fixing (11SOV)



Wheel Dia mm	Tread Width mm	Fitted Height mm	Swivel Offset mm	Load Capacity kgs	Bearing Type	Swivel	Fixed	Swivel + Total Stop Brake
100	30	128	32	85	roller	411SOV PSBW BH10		411SOV PSBW BH10 SWB
125	30	152	47.5	85	ball	511SOV PSWBJ BH10		511SOV PSWBJ BH10 SWB

Hydraulic Pumps and Power Packs



We supply a range of Hydraulic Pumps and Power Packs to pressurise our range of Hydraulic Rams, Hydraulic Tiffors and Hydraulic machinery. Our larger Power Packs are available with electric and petrol motors.

Floor cranes, Scissor tables, Trolley jacks, Bottle jacks



Floor cranes are robust, versatile and fully folding for easy storage. There are three models available with max lifting capacities from 500kg – 2000kg. Each model is fitted with hardwearing polyamide wheels and castors for smooth and quiet operation. The three position fully extendable jib is fitted with a handle to facilitate easy positioning and is complete with lifting hook.

Applications - machinery and engine removal and in machine shops

Hydraulic jacks



Force 5 tonne
Stroke 175mm

Features
Reduced front profile, claw manufactured in high tensile steel, lifting capacity 5 tonne on the head and on the claw, lateral stability, easy application and built in relief valve.

Application widely used in the machinery moving, mining, ship repair and railway industries.

Hydraulic Rams & Cylinders



We supply a range of Hydraulic Rams and Cylinders both single and double acting, to lift up to 1000 tonne. Please state safe working load, closed height and stroke of ram when ordering.

Loose Hydraulic pullers and Nut cutters



Mechanical manufactured in high quality steel to ensure reliability and long life.

Hydraulics consisting of a PS or PL pumps, a cylinder from the CMF range with ZTE threaded hollow saddle, an SN20M hose assembly and G106L pressure gauge.

Applications:

Indispensable when extracting gears, bearing, couplers and bushings etc.

Industrial Cylinders Double Acting



- Force 10 - 500 t
- Stroke 150 - 325mm
- Maximum Pressure 700bar

Model	Pushing Force (t/kH)	Pulling Force (t/kH)	Stroke	Pushing Oil Volume	Pulling Oil Volume	Closed Height A (mm)	Extended Diameter D (mm)	Weight (kg)
C0170N150	10/111	5/55	150	239	118	258	60	5.2
C0170N250	10/111		250	398	197	358		6.8
C0130N150	30/309	10/111	150	663	239	279	100	15.5
C0130N250		10/111	250	1104	398	379		20.5
C0150N150	50/496	15/144	150	1063	309	288	127	24.5
C0150N325		15/144	325	2304	670	463		47.0
C01100N150	100/929	38/379	150	1991	813	323	175	55
C01100N300		38/379	300	3982	1426	473		77

Lightweight Hand Pumps - 700 bar



These hand pumps very lightweight and are made from alloy metal. They deliver exceptional volumes of oil per stroke and require very low handle effort offering mechanical resistance and durability these pumps can work vertically or with pumping head pointing downwards.

- Reservoir Capacity 0.7 - 8.0 litres
- Oil per stroke in HP 1.0
- Pressure 700bar

Model	Pressure 1st Stage (bar)	Pressure 2nd Stage (bar)	Oil Delivery 1st Stage (cm ³)	Oil Delivery 2nd Stage (cm ³)	Handle Effect (N)	For use with	Reservoir Capacity (litres)	Usable Oil Volume (litres)	Weight (kg)
PL130	-	700	-	1.0	260	Single Acting	0.7	0.5	3.2
PL131				3.4	340		1.3	1.1	6.0
PL132				3.4	340		2.4	2.1	6.5
PL140	20	700	10.3	1.0	340	Single Acting	0.7	0.5	3.2
PL141							1.3	1.1	5.0
PL142	30	13.7	2.2	350	2.4		2.1	6.5	
PL162	70	700	32	3.0	340	Single Acting	2.4	2.1	7.0
PL164							4.3	3.8	11.2
PL168							8.0	6.6	16.7
PL262	70	700	32	3.0	340	Double Acting	2.4	2.1	7.8
PL264							4.3	3.8	12.0
PL268							8.0	6.6	17.6

High Tonnage Cylinders with Safety Ring Nut, Load Return



- Force 30 - 500 t
- Stroke 25 - 50mm
- Maximum Pressure 700bar

Model	Pushing Force (t/kH)	Stroke	Pushing Oil Volume	Closed Height A (mm)	Extended Diameter D (mm)	Weight (kg)
C6630N100	30/309	100	442	189	102	11
C66350P100	50/496	100	709	208	127	19
C6650P150		150	1063	258		23
C66100P100	100/929	100	1327	236	175	38
C66100P150		150	1991	286		45

Low Profile Cylinders Spring Return



- Force 10 - 100 t
- Stroke 25 - 50mm
- Maximum Pressure 700bar

Model	Pushing Force (t/kH)	Stroke	Oil Volume	Closed Height A (mm)	Extended Diameter D (mm)	Weight (kg)
CMP10N25	10/111	25	40	72	75	2.5
CMP10N50		50	80	97		3.2
CMP20N25	20/198	25	71	75	88	3.4
CMP10N50		50	141	100		4.2
CMP30N25	30/309	25	110	86	102	5.0
CMP30N50		50	221	111		4.1
CMP50N25	50/496	25	177	97	127	7.6
CMP50N50		50	354	122		9.1
CMP100N25	100/929	25	332	116	175	17.6
CMP100N50		50	664	141		20.5



**LIFTING SOLUTIONS
& CORPORATE SERVICES**

- **INSPECTION, TESTING & CERTIFICATION**
Inspection services to industry for nearly 200 years. Offering mechanical, tensile and compression structure testing. Full certification of all types of lifting equipment & compliance with legal requirements of LOLER & PUWER.
- **PRESSURE SYSTEMS and LEV's**
- **DESIGN, REPAIR & MANUFACTURE**
Providing solutions to unusual problems, managing entire projects and providing unparalleled service in renovating & refurbishment equipment.
- **MAINTENANCE SERVICES**
Leaders in preventative maintenance for cranes, hoists, lifts and industrial doors - tailored to suit your needs.
- **TRAINING SERVICES**
- **A WORLDWIDE PROVIDER OF HEALTH, SAFETY AND CONSULTANCY SERVICES**



Testing

Testing & Certification

Lloyds British Engineering Services has unrivalled first hand experience of all kinds of testing techniques across a broad range of industries. We have qualified, expert personnel throughout the U.K and Internationally, and can offer:-

- Mechanical, tensile and compression testing up to 2,000 tonnes
- Testing either on-site or at fully certified and equipped test centres
- Over 2,000 tonnes of calibrated test weights
- Pre-inspection on cranes before testing
- Compliance with relevant quality standards of many major authorities and industries
- A speedy, efficient, quality service throughout the U.K and Europe.
- All work fully certified for legal compliance
- A complete manufacture, repair and testing service

Mechanical Testing

Our comprehensive facilities allow us to undertake a vast range of mechanical tests. These include:-

- Lifting equipment testing to meet any safety or quality standards
- Routine testing of chain and rope, to destruction if necessary
- Verification or calibration of S.W.L. for all types of lifting appliances from cranes to winches
- Specially fabricated structures tested for all industries
- Testing of ships and oil rig mooring anchors and a wide range of testing in ports and docks
- Testing of mobile cranes, fork lift trucks, lorry-mounted cranes, tail lifts, breakdown trucks etc.
- Testing to meet the specialised needs of any customer
- Floor loading tests
- Testing of ships' bows, passenger walkways and linkspans
- Testing of crush barriers, balustrades, street decorations, maintenance and window cleaning equipment
- Safety harness anchorage point testing
- We can audit your existing records if required and we are pleased to invite customers to witness tests

Inspection and Certification

Inspection Services

Lloyds British Engineering Services has been providing contract inspection to the industry for almost 200 years. Our vast experience includes specialist programmes for:-

- Cranes
- Hoists
- Loose lifting equipment
- Offshore equipment
- Local Exhaust Ventilation equipment
- Pressure Vessels
- Lifts
- Forklift Trucks
- Mobile Cranes
- Structures and more...

Our nationwide team of qualified engineers is equipped with personal hand held computers to provide immediate on-site reports either on paper or as a computer file. We offer certification, audit and inspection services, and can ensure that plant registers are kept up to date and legal obligations are fully met. Lloyds British colour coding schemes can be implemented to promote safe practice in the workplace.

Where third party verification is required Lloyds British Engineering Services will make sure that full documentation is provided and correct procedures are followed.

Innovation

Lloyds British Testing provide an extranet solution, which is a powerful web-based system for online collaboration. Using a web browser-based interface, it enables us to create private, secure collaborative areas of a web site. Each private extranet site provides all the tools we need to share documents, data, contracts, news, calendars and more. The extranet helps you work more effectively by providing a central repository for critical business information that can be assessed at anytime from anywhere.

Lloyds British Testing operate their own bespoke Microsoft Access database system, which can be tailored to suit individual needs. An individually formatted spreadsheet can easily be exported to give immediate indication of whether equipment is safe to use, inspection date, next inspection due date and details of equipment status i.e. defect, missing, unavailable or none.



ROTADAVITS

Provide a simple portable method of lifting when used in conjunction with a chain block, ratchet lever hoist or winch, and can be assembled easily. There are a range of davits and sockets to suit your application. Rotadavits are designed and manufactured to BS 7333.



SWING JIB CRANES

Manufactured to customer specification and BS 7333. Jibs can be mounted onto a suitable concrete base, structural columns, pillars, walls or directly onto machinery. Options include manual or powered hoisting, manual or powered slew up to 360°, underbraced, overbraced and knuckle design.



CRANES/MONORAILS/GANTRIES

Our expertise extends across the full spectrum of fabrication offering simple or complex solutions to meet your specific needs. Systems can be manual or powered ranging from light construction to double girder EOTC, incorporating track switches, turntables, drop sections and latching devices if required.



LIFTING BEAMS/FRAMES/GRABS/TONGS

Lifting and handling is as diverse and challenging as the variety of items that are required to be lifted. Rota specialise in designing, manufacturing and testing many different beams, frames and handling devices to meet your requirements.



VACUUM LIFTING

Rota have designed and manufactured vacuum systems for major organisations in a variety of industries including aerospace, concrete, glass, metals processing and general engineering. All Rota vacuum systems are designed to meet specific customer needs and comply with relevant guidelines.



BESPOKE HANDLING EQUIPMENT

Rota's designers are experienced in producing pneumatic, hydraulic, motorised and manual equipment. Therefore when given an unusual or difficult handling problem we are able to apply a wealth of talent and experience to provide a tailored solution.

Swing Jibs Cranes Monorails Gantries Lifting Beams Platforms/Staircases Pump Chains Loose Lifting Equipment Proof Load Testing

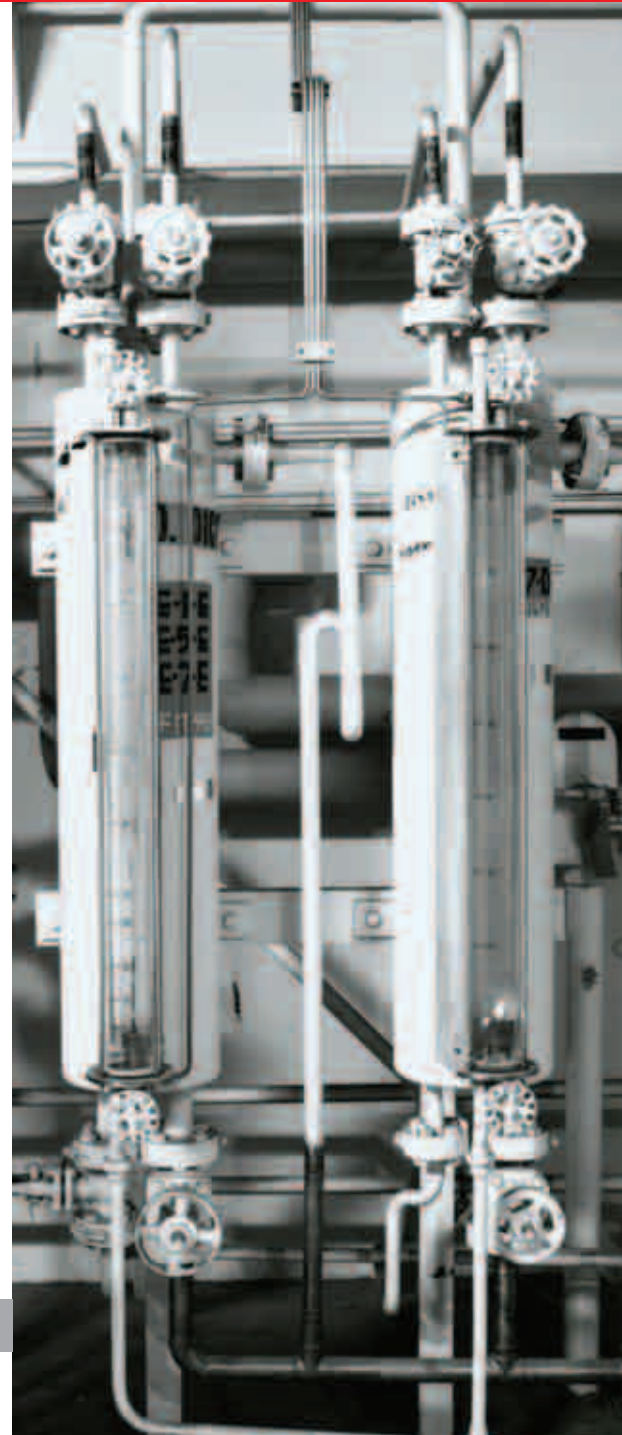

Lloyds British Engineering Services offers the complete pressure systems service for testing and inspection, consultancy and certification to PSSR 2000

- Pressure testing carried out using equipment and procedures approved by Lloyds Register of Shipping
- Mobile testing for on-site work
- Complete de-commissioning, repair and re-commissioning service where required
- Comprehensive range of supplementary techniques available; such as NDT, endoscopy etc.
- Pressure system surveys to advise on compliance with regulations
- Production and certification of written schemes of examination

Our inspection, testing and certification work is scheduled and carried out to ensure minimum disruption, minimum down time and maximum productivity.

Qualified engineers and an independent, fully guaranteed, reliable and cost-competitive service ensures full compliance with the law and peace of mind.

Local Exhaust Ventilation Equipment Control of Substances Hazardous to Health Regulations 2002

Lloyds British Testing's inspection engineers can carry out thorough examinations and testing using smoke tubes/bombs, vane anemometers and pitot tubes/manometers to ensure your equipment adequately controls hazardous substances in the workplace

Typical high risk areas are:

- Welding Bays
- Shot Blasting Areas
- Fume Cupboards
- Metal Grinding Areas
- Around Wood Working Machinery
- Areas where Noxious Gases are/could be released in the workplace

Global Handling Solutions

Motorised Coil Lifters

From the most advanced Coil Sensitive Telescopic Coil Lifters to basic C Hooks. Somers will provide the product to meet your requirements.

Lifting Systems

Bespoke applications to suit particular problems. Somers have a wealth of experience in the design, manufacture and supply of both manual and automatic material handling systems.

Tongs

Gravity Tongs using the ultra reliable Somers Automatic Mechanism or Hydraulic/Motorised tongs are available to suit both hot and cold product handling. Capacities range from 100 kg to 200 tonnes.

Slab and Pack Handlers

Push button controlled to provide a safe handling solution without manual intervention to protect your workforce and facilities.

Grabs

In instances where the component shape or access is a problem. Give Somers the chance to provide a grab to suit.

Slewing Hooks

Uncontrolled rotation of loads can result in injury to personnel and dangerous occurrences. Somers Slewing Hooks enable the operator to accurately position and rotate loads in a safe and efficient manner.

Sheet Lifters

If you take away the manual element of sheet handling, you take away the hazard. Somers Telescopic Sheet Pack Lifters are motorised to remove the hazard.

Downenders

Vertically Cast Aluminium Slabs are safely downended with Somers Slab Downenders, developed to suit the requirements of the world's major Aluminium producers. If you need to downend, upend, tilt or rotate anything, give Somers the chance to provide a safe and efficient solution.



Our maintenance packages are tailored to suit our clients and designed to assist in controlling budget expenditure and cost fixing throughout the year.

Standard Maintenance Agreement

- Covering Routine Maintenance at agreed intervals
- Annual Assessment

Standard Maintenance Agreement Plus

- Covering Routine maintenance at agreed intervals
- Annual Assessment
- Emergency Call Outs (Labour Only)

Comprehensive

- Covering Routine maintenance at agreed intervals
- Annual Assessment
- Emergency Call Outs
- Replacement of minor lift components

Comprehensive Plus

- Covering Routine maintenance at agreed intervals
- Annual Assessment
- Emergency Call Outs
- Replacement of minor lift components
- Replacement of major lift components

We supply and install a wide variety of lifts to suit all our customers different needs.

Passenger/Good Lifts

Hydraulic/Traction/Lifts of varying capacities. Service Lifts for Restaurants and Hotels, Scenic Lifts for Hotels, Offices and Shopping Centres.

Access Lifts

Conforming to 2004 Disabled Regulations. To provide access for all persons to public buildings.

Explosion Proof Lifts

For use in the Petrochemical Industry and Other Hazardous Zones.

Platform Lifts

For Loading Bays. Together with the technology to design and construct any lift to your specification. All conforming to the relevant European Standards.

Lloyds British are providers of:

- Maintenance/Inspection
- Repairs
- Modernisation/Refurbishment
- Supply of new and refurbished Lifts into the market place
- Consultation
- On Site Training

Operating from 10 locations, with Technical offices in Mexborough, our team of engineers is available 24 hours a day to service the needs of our clients.



Lloyds British Training Services is one of the UK's leading training providers in the field of general safety and materials handling and is firmly established as a truly worldwide training body organisation.

With a prestigious portfolio of clients ranging from small enterprises to major blue chip companies, many of the world's major organisations rely on Lloyds British to improve safety standards by training their employees. Without doubt the market leader in Lifting and Slings training, Lloyds British can offer over 80 separate programmes of workplace instruction to meet the requirements of most industries and workplace environments.

Courses can be delivered for operative level personnel through to Instructor standard and assess and test and / or refresher programmes are also available. All programmes can be delivered onsite and certification, licensing and exhaustive course hand outs are provided.

As Industry leader in professional standards, our associations with LEEA and other professional bodies confirm our status as a natural choice for statutory and general safety training. With the capability to also provide advice and guidance Lloyds British can act as safety practitioners performing workspace safety functions on your behalf.



USE LLOYDS, THE LEADER IN THE FIELD

Visit our website – www.lloydsbritishtraining.com or call 0870 197 5575 and speak to one of our specialists.

A WORLDWIDE TRAINING SERVICES PROVIDER

LIFTING EQUIPMENT

Bespoke Handling Equipment	15	Mechanical Grab	20	Saflok Beam Trolley	14
Block Grabs	20	Miller Web	3	Shackles	9-10
Electric Chain Hoists	12	Minifor Powered Hoist	16	Stainless Steel Chain	7
Eye Bolts	11	One-man Battery Slab Lifter	21	Stone Magnet	21
Gantrys	17	Paver Transport Cart	21	Tirak Wire Rope Hoist	16
Hand Chain Hoists	12	Pewag Winner	5-6	Vacuum Slab Lifter	20
Kerb Lifters	19	Pneumatic Chain Hoists	12	Vital Geared Beam Trolley	13
Kuplex	4	Ratchet Lever Hoist	12	Vital Push Travel Trolley	13
Lifting & Pulling Machines	16	Rough Terran Pallet Truck	19	Wire rope	8
Manhole Cover Lifter	19	Saflok Beam Clamp	14	Wire Rope Winches	18

LOAD MEASUREMENT

Hand Weights	22	Tension Load Links	22
Load Cell Shackles	22	Test Weights	22

SAFETY EQUIPMENT

Fall Protection Jacket	23	Fall Protection Vests	25	Safety Helmets	26
Fall Protection Overall	24	Safety Harnesses	27-30		

MATERIAL HANDLING

Drum Grab	31	Genie Super Lift	32	Sack Trucks	33
Fork Mounted Hook	31	Pallet Trucks	35-36	Scissor Lifting Table	32
Fork Mounted Jib	31	Panel Trucks	37	Wheels	38-40
Gas Operated Lift	32	Platform Trucks	34		

JACKING EQUIPMENT

High tonnage Cylinders	45	Hydraulic Rams	43	Light Weight Hand Pumps	44
Hydraulic Jack	42	Hydraulic Pullers	43	Low Profile Cylinders	45
Hydraulic Pumps	41	Industrial Cylinders	44		

Our terms and conditions are clearly identified on the reverse of the delivery note. For a copy please telephone Lloyds British Head Office on 0870 197 5500. In this catalogue Lloyds British have illustrated a range of equipment which are offered subject to availability. However, there may be circumstances which lead us to offering alternative equipment, all of which are brands that meet our quality control procedure. Whilst every care and attention has been taken to describe the equipment in detail, customers are reminded to check with our experienced sales staff at the time of order.

No part of this publication may be copied or used in any way, shape or form without the express permission in writing by a director of Lloyds British Testing Ltd. The images and technical data used in this publication are for illustration purposes only.